

# SEATTLE PROGRAM CENTER

## FACILITY RENTAL INFORMATION



**THE  
MOUNTAINEERS**

# GOODMAN AUDITORIUM

Our building has two main meeting rooms, the largest of which is our Goodman Auditorium. You can book the full auditorium for larger events, or rent smaller sections separated by air-walls. The Goodman C section contains our indoor climbing wall, which is often an inspirational curiosity for event attendees.



Goodman A and B, looking north

## **FULL AUDITORIUM**

**Size:** 42'x108'

**Weekday (M-F):** \$882 for 4 hrs/\$1200 for 8 hrs

**Weekend (Sat-Sun):** \$1365 for 4 hrs/\$2500 for 8 hrs

**Seating Capacity:** Theater: 500; Banquet: 300; Classroom: 225

**AV:** 2 screens with audio-visual setup available

**Ideal for:** film festivals, conferences, presentations, auctions

## **GOODMAN A & B**

**Size:** 42'x84'

**Weekday (M-F):** \$700 for 4 hrs/\$1100 for 8 hrs

**Weekend (Sat-Sun):** \$1100 for 4 hrs/\$1900 for 8 hrs

**Seating Capacity:** Theater: 300; Banquet: 200; Classroom: 150

**AV:** 2 screens with audio-visual setup available

**Ideal for:** workshops, conferences, presentations

## **GOODMAN B & C**

**Size:** 42'x66'

**Weekday (M-F):** \$615 for 4 hrs/\$1000 for 8 hrs

**Weekend (Sat-Sun):** \$1000 for 4 hrs/\$1674 for 8 hrs

**Seating Capacity:** Theater: 220; Banquet: 150; Classroom: 115

**AV:** 1 screen on the east wall, with audio-visual setup available

**Ideal for:** workshops, conferences, presentations



Goodman C, looking south with climbing wall.

## **GOODMAN A OR B (ROOMS ARE THE SAME SIZE)**

**Size:** 42'x42'

**Weekday (M-F):** \$410 for 4 hrs/\$645 for 8 hrs

**Weekend (Sat-Sun):** \$645 for 4 hrs/\$1060 for 8 hrs

**Seating Capacity:** Theater: 160; Banquet: 100; Classroom: 75; Conference: 50

**AV:** each section has a screen and audio-visual setup available

**Ideal for:** workshops, small gatherings, meetings

## **GOODMAN C**

**Size:** 24'x35'

**Weekday (M-F):** \$294 for 4 hrs/\$500 for 8 hrs

**Weekend (Sat-Sun):** \$378 for 4 hrs/\$620 for 8 hrs

**Seating Capacity:** Theater: 60; Banquet: 50; Classroom: 40; Conference: 36

**AV:** Pop-up screen and audio-visual setup is available

**Ideal for:** workshops or meetings



Top, left to right: Cascade room, Program center lobby

# CASCADE

The Cascade is the smaller of our two main meeting rooms. You can book the full room for medium-sized events, or rent a smaller section separated by an air-wall.

## **CASCADE - FULL ROOM**

**Size:** 23'x42'

**Weekday (M-F):** \$336 for 4 hrs/\$520 for 8 hrs

**Weekend (Sat-Sun):** \$410 for 4 hrs/\$645 for 8 hrs

**Seating Capacity:** Theater: 70; Banquet: 50; Classroom: 36; Conference: 36

**AV:** 1 screen and audio-visual setup available

**Ideal for:** workshops, presentations, meetings

## **CASCADE A OR B**

**Size:** 21'x23'

**Weekday (M-F):** \$240 for 4 hrs/\$280 for 8 hrs

**Weekend (Sat-Sun):** \$280 for 4 hrs/\$400 for 8 hrs

**Seating Capacity:** Theater: 25; Banquet: 20; Classroom: 12; Conference: 18

**AV:** 1 screen and audio-visual setup available. Cascade A comes with a built-in projection screen, and a pop-up screen is available to use for Cascade B.

**Ideal for:** small meetings or workshops

## ADDITIONAL INFORMATION

The minimum rental time is four hours. Your rental price will be prorated by the hour if you need the space longer. We do not have a kitchen on site, but a staging area will be provided. Please contact us about our list of preferred caterers. Call or email for more details regarding our decoration policies. Our facility is not available for weddings.

**To see space availability, visit**

[mountaineers.org/SeattleProgramCenter/AllEvents](https://mountaineers.org/SeattleProgramCenter/AllEvents)



Top, left to right: Program center lobby, and program center entrance.

## EQUIPMENT INFORMATION

Item	Qty.	Price
<b>TABLES AND CHAIRS</b>		
60" Round Tables	26	Included
6' White Plastic Tables	25	Included
6' Wood Table	25	Included
1.5' x 5' Wood Table	9	Included
30" Cocktail Table (with black linens)	6	\$15 each
Stackable chairs - Brown	75	Included
Stackable Chairs - Grey	447	Included
<b>AV EQUIPMENT</b>		
Podium (standing and tabletop)	3	Included
Portable Projector Screen	3	Included
LCD Projector	5	\$50
Wired Hand-held Microphone	4	1st Included
Microphone (wireless hand-held, lapel, headset)	9	\$25 each
Large Easel	4	Included
Flip chart Easel (w/o Paper)	5	Included
Flip charts	N/A	\$15 each
White Board (Portable)	2	Included
16'x 8'x 16" stage (modular with 4'x 4' panels)	N/A	Inquire
Audio hookup for presentations	N/A	Included

# THE MOUNTAINEERS SEATTLE PROGRAM CENTER MAP

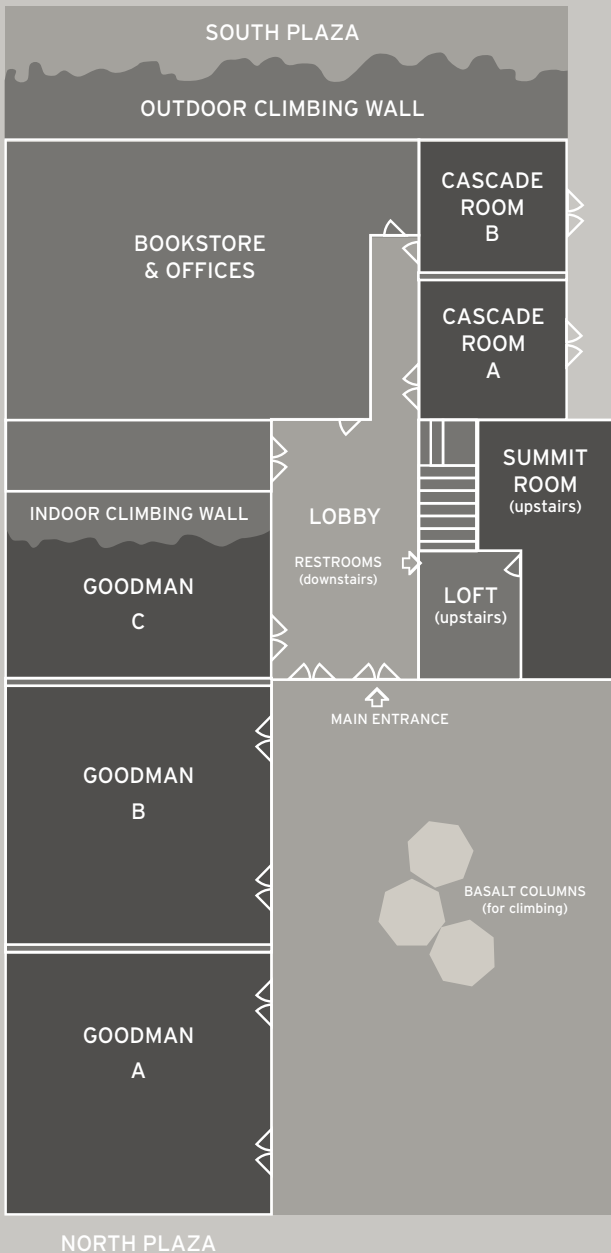



The outdoor ambiance of the facility combined with quality amenities make The Mountaineers Program Center a unique location for your next workshop, fundraiser or social gathering.

We offer a variety of rooms that can accommodate 10-500 people - anything from a small meeting to a large film festival. Room rentals come with modern AV capabilities in addition to friendly and knowledgeable staff to help make your program a success. Parking is abundant and free.



The Mountaineers is a 501(c)(3) non-profit organization. Our mission is to enrich the community by helping people explore, conserve, learn about and enjoy the lands and waters of the Pacific Northwest and beyond.

7700 Sand Point Way NE  
Seattle, Washington 98115  
rentals@mountaineers.org  
206-521-6005

[mountaineers.org/SeattleProgramCenter](https://www.mountaineers.org/SeattleProgramCenter)