

THE MOUNTAINEERS
SEATTLE PROGRAM CENTER MAP

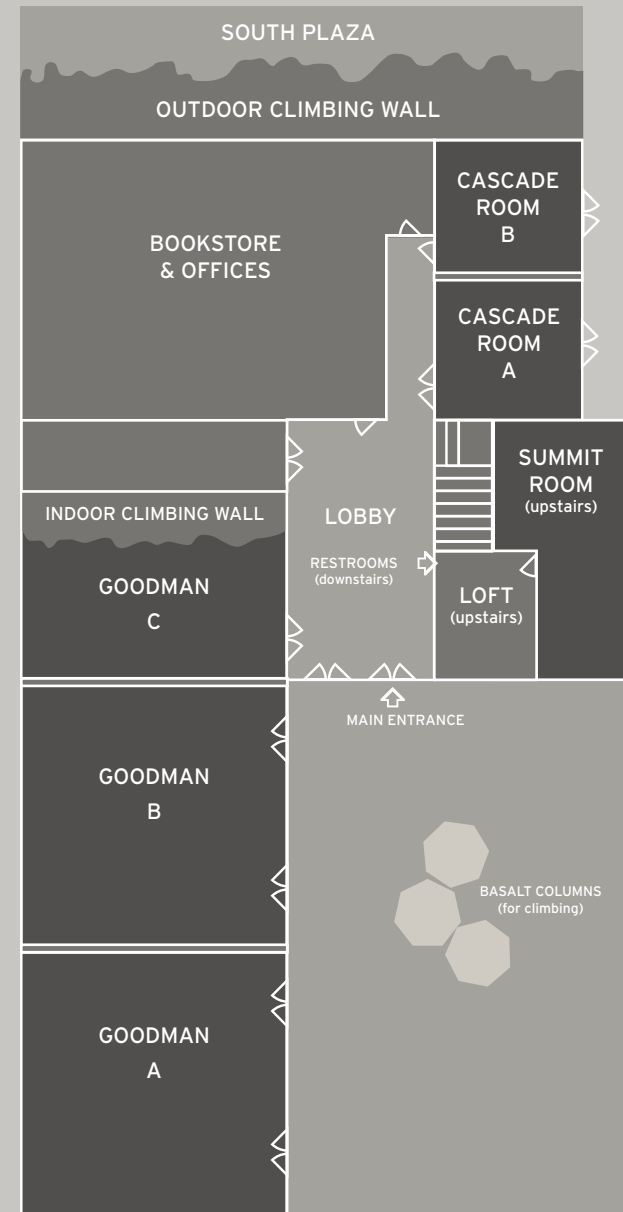

NORTH PLAZA

not to scale - for directional use only

The outdoor ambiance of the facility combined with quality amenities make The Mountaineers Program Center a unique location for your next workshop, fundraiser or social gathering.



We offer a variety of rooms that can accommodate 10-500 people - anything from a small meeting to a large film festival. Room rentals come with modern AV capabilities in addition to friendly and knowledgeable staff to help make your program a success. Parking is abundant and free.

SEATTLE
PROGRAM CENTER
FACILITY RENTAL INFORMATION



The Mountaineers is a 501(c)(3) non-profit organization. Our mission is to enrich the community by helping people explore, conserve, learn about and enjoy the lands and waters of the Pacific Northwest and beyond.

7700 Sand Point Way NE
Seattle, Washington 98115
rentals@mountaineers.org
206-521-6005
mountaineers.org/SeattleProgramCenter



GOODMAN AUDITORIUM

Our building has two main meeting rooms, the largest of which is our Goodman Auditorium. You can book the full auditorium for larger events, or rent smaller sections separated by air-walls. The Goodman C section contains our indoor climbing wall, which is often an inspirational curiosity for event attendees.

GOODMAN B & C

Size: 42'x66'
Weekday (M-F): \$585 for 4 hrs/\$950 for 8 hrs
Weekend (Sat-Sun): \$920 for 4 hrs/\$1595 for 8 hrs
Seating Capacity: Theater: 220; Banquet: 150; Classroom: 115
AV: 1 screen on the east wall, with audio-visual setup available
Ideal for: workshops, conferences, presentations



Top, left to right: Cascade room, program center lobby, and program center entrance.



Top, left to right: Goodman A and B, looking north; Goodman C, looking south with climbing wall.

FULL AUDITORIUM

Size: 42'x108'
Weekday (M-F): \$840 for 4 hrs/\$1150 for 8 hrs
Weekend (Sat-Sun): \$1300 for 4 hrs/\$2360 for 8 hrs
Seating Capacity: Theater: 500; Banquet: 300; Classroom: 225
AV: 2 screens with audio-visual setup available
Ideal for: film festivals, conferences, presentations, auctions

GOODMAN A & B

Size: 42'x84'
Weekday (M-F): \$665 for 4 hrs/\$1050 for 8 hrs
Weekend (Sat-Sun): \$1050 for 4 hrs/\$1800 for 8 hrs
Seating Capacity: Theater: 300; Banquet: 200; Classroom: 150
AV: 2 screens with audio-visual setup available
Ideal for: workshops, conferences, presentations

GOODMAN A OR B (ROOMS ARE THE SAME SIZE)

Size: 42'x42'
Weekday (M-F): \$390 for 4 hrs/\$615 for 8 hrs
Weekend (Sat-Sun): \$615 for 4 hrs/\$1010 for 8 hrs
Seating Capacity: Theater: 160; Banquet: 100; Classroom: 75; Conference: 50
AV: each section has a screen and audio-visual setup available
Ideal for: workshops, small gatherings, meetings

GOODMAN C

Size: 24'x35'
Weekday (M-F): \$280 for 4 hrs/\$475 for 8 hrs
Weekend (Sat-Sun): \$360 for 4 hrs/\$590 for 8 hrs
Seating Capacity: Theater: 60; Banquet: 50; Classroom: 40; Conference: 36
AV: Popup screen and audio-visual setup is available
Ideal for: workshops or meetings

CASCADE

The Cascade is the smaller of our two main meeting rooms. You can book the full room for medium-sized events, or rent a smaller section separated by an air-wall.

CASCADE - FULL ROOM

Size: 23'x42'
Weekday (M-F): \$320 for 4 hrs/\$495 for 8 hrs
Weekend (Sat-Sun): \$390 for 4 hrs/\$615 for 8 hrs
Seating Capacity: Theater: 70; Banquet: 50; Classroom: 36; Conference: 36
AV: 1 screen and audio-visual setup available
Ideal for: workshops, presentations, meetings

CASCADE A OR B

Size: 21'x23'
Weekday (M-F): \$225 for 4 hrs/\$270 for 8 hrs
Weekend (Sat-Sun): \$275 for 4 hrs/\$385 for 8 hrs
Seating Capacity: Theater: 25; Banquet: 20; Classroom: 12; Conference: 18
AV: 1 screen and audio-visual setup available. Cascade A comes with a built-in projection screen, and a popup screen is available to use for Cascade B.
Ideal for: small meetings or workshops

ADDITIONAL INFORMATION

The minimum rental time is four hours. Your rental price will be prorated by the hour if you need the space longer. We do not have a kitchen on site, but a staging area will be provided. Please contact us about our list of preferred caterers. Call or email for more details regarding our decoration policies. Our facility is not available for weddings.

To see space availability, visit mountaineers.org/SeattleProgramCenter/AllEvents

EQUIPMENT INFORMATION

Item	Qty.	Price
TABLES AND CHAIRS		
60" Round Tables	26	Included
6' White Plastic Tables	25	Included
6' Wood Table	25	Included
1.5' x 5' Wood Table	9	Included
Stackable chairs - Brown	75	Included
Stackable Chairs - Grey	447	Included
AV EQUIPMENT		
Podium (standing and tabletop)	3	Included
Portable Projector Screen	3	Included
LCD Projector	5	\$50
Wired Handheld Microphone	4	Included
Microphone (wireless handheld, lapel, headset)	9	\$25 each
Large Easel	4	Included
Flipchart Easel (w/o Paper)	5	Included
Flipcharts	N/A	\$15 each
White Board (Portable)	2	Included
DVD Player	2	\$25
Audio hookup for presentations	N/A	Included